

# TOWNSHIP 2 N., RANGE 7 W.W.M. TILLAMOOK COUNTY ORE.

SCALE 2 IN. = 1 MILE.

CHAS. F. METSKER CIVIL ENGINEER  
514 S.W. OAK STREET, PORTLAND, ORE.  
111 SO. TENTH STREET, TACOMA, WASH.

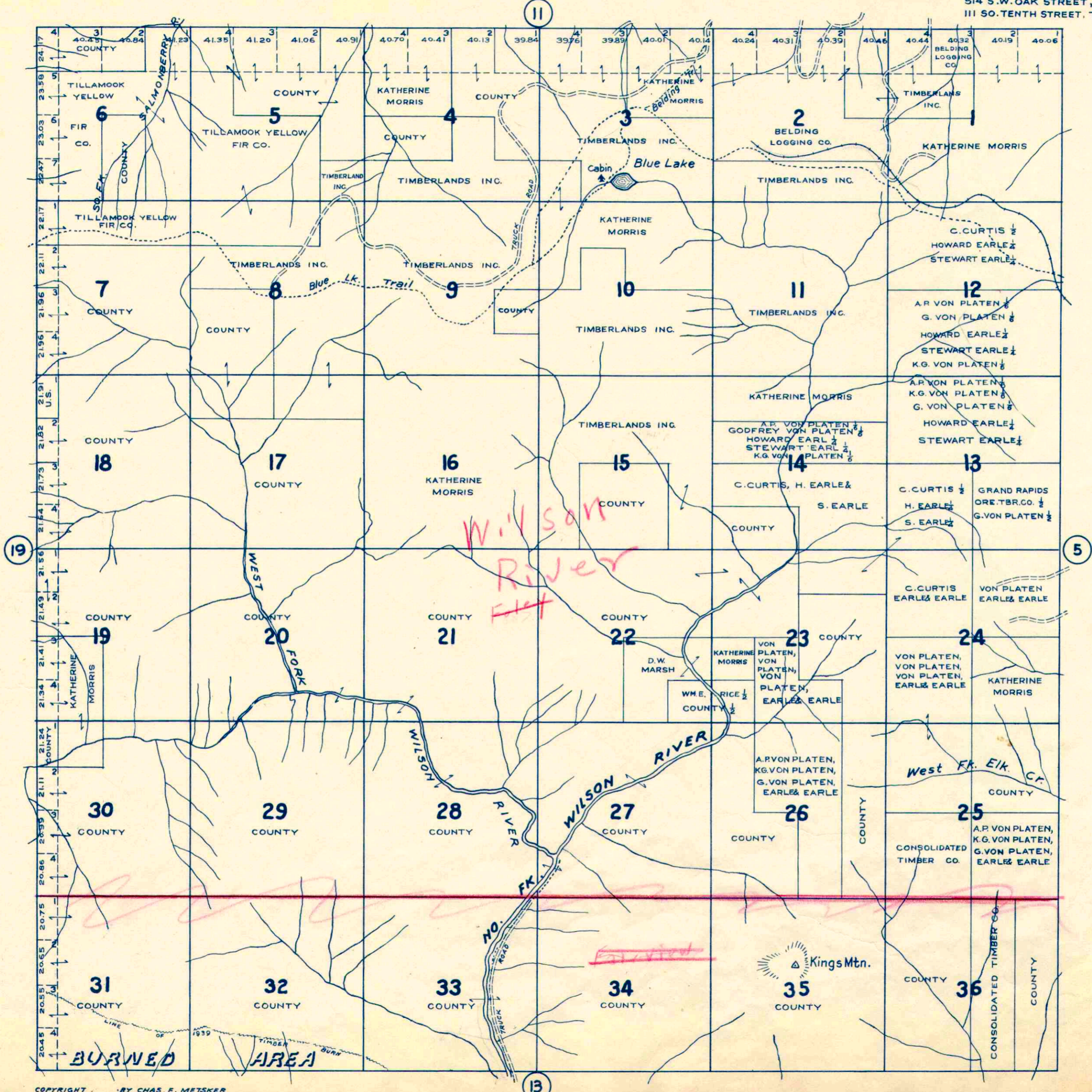

- LEGEND —
- PAVED ROADS
  - IMPROVED DIRT ROADS
  - OTHER ROADS
  - TRAILS
  - RAILROADS
  - ELE. RWYS.
  - SCHOOLS